

Swivel Cartridge

The Screw-in Cartridge is the result of the shank-nut assembly and it is designed to be integrated into hydraulic manifolds. It simply screws in, becoming a short and very sturdy swiveling coupling that will live through high pressure and side loads.



Applications



Technical Specifications

dash	Size		Working Pressure (MPa)	Flow Rate (l/min)	Spillage (ml)	Force to Connect (N)	Burst pressure (MPa)		
	mm	inch					Male	Female	Male + Female
08	12.5	1/2"	43 MPa				172		
12	20	3/4"	43 MPa				172		
16	25	1"	43 MPa				172		
20	31.5	1-1/4"	38 MPa				152		

Material

Steel

Seals

FKM

Working temperatures

-40 °C to 180 °C

Surface treatment

MATE 500 (CrIII)

Series Interchange

Valve Type

Connection

Disconnection

Connection
Under Pressure

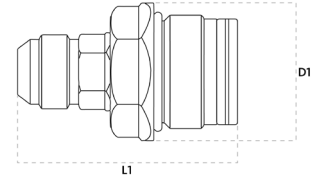

Swivel Cartridge

Size		Thread details							
mm	inch	Thread Type	Thread Standard	Thread	Part Number	L1		D1	
						mm	inch	mm	inch
12,5	1/2"	03/ METRIC	ISO 8434-1-S	M30x2 MALE 20S	S20803LMXXX-10V000	77	3,03	53,1	2,09
12,5	1/2"	16/ BSPP	ISO 8434-6	60° 1/2 BSPP MALE	S20816DGXXX-10V000	60	2,36	39	1,54
12,5	1/2"	13/ SAE	ISO 8434-2	3/4"-16 UNF MALE JIC	S20813FSXXX-10V000	63,5	2,5	37,3	1,47
20	3/4"	11/ SAE	ISO 8434-3	1-3/16"-12 UN MALE ORFS	S21211HSXXX-10V000	76,3	3	53,1	2,09
20	3/4"	16/ BSPP	ISO 8434-6	G 3/4"	S21216FGXXX-10V000	76,3	3	50	1,97
20	3/4"	13/ SAE	ISO 8434-2	1-1/16"-12 UN MALE JIC	S21213HSXXX-10V000	80	3,15	50	1,97
25	1"	11/ SAE	ISO 8434-3	1-7/16"-12 UN MALE ORFS	S21611LSXXX-10V000	88,1	3,47	58,7	2,31
25	1"	16/ BSPP	ISO 8434-6	G 1"	S21616GGXXX-10V000	88,1	3,47	56,4	2,22
25	1"	13/ SAE	ISO 8434-2	1 - 5/16" - 12 UN	S21613LSXXX-10V000	90,5	3,56	56,4	2,22
31,5	1-1/4"	11/ SAE	ISO 8434-3	1-11/16"-12 UN MALE ORFS	S22011MSXXX-10V000	93,7	3,69	69,1	2,72
31,5	1-1/4"	16/ BSPP	ISO 8434-6	G 1 1/4"	S22016HGXXX-10V000	93,2	3,67	69,1	2,72

