



RF

Screw to connect couplings for air conditioning & refrigeration application.

This range of couplings has been specifically designed for air conditioning and refrigeration systems. Interchangeability according to market driven standards. Couplers in steel material, available in both versions with or without adaptor. Wide range of loose supplied adaptors available.



Applications



Technical Specifications

dash	Size		Working Pressure (MPa)	Flow Rate* (g/s)	Air inclusion and fluid loss (cc max)	Maximum leakage rate** (g/year)	Burst pressure (MPa)		
	mm	inch					Male	Female	Male + Female
04	6.3	1/4"	33	20	0.02	1	53	10.5	100
06	10	3/8"	23.3	44	0.05	1	34	19	70
08	12.5	1/2"	18.3	107	0.1	1	55	15	55
12	20	3/4"	14.3	288	0.1	1	43	15	43
16	25	1"	12.3	477	0.2	1	12	15	37

* Flow rate calculated considering air in standard conditions (20°C, 1 bar). For other gases refer to density table on page 241.

** R22 equivalent refrigerant, at operating range, both connected and disconnected.

Material	Steel
Seals	CR (Neoprene)
Working temperatures	- 40 °C to + 120 °C
Surface treatment	MATE 500 (CrIII)
Series Interchange	MARKET

Valve Type	Flat
Connection	Screw to Connect
Disconnection	Unscrew to Disconnect
Connection Under Pressure	Allowed Residual



RF

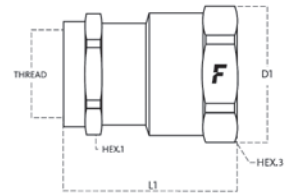

Size		Thread details			FEMALE									
mm	inch	Thread Type	Standard	Thread	Part Number	L (L1 + Thread)		D1		Hex1		Hex3		
						mm	inch	mm	inch	mm	inch	mm	inch	
6.3	1/4"	O/ SAE	ASME B1.1	1/2" -20 UNF FEMALE ORB	RF 04 F N	28.7	1.13	21.0	0.83	16.0	0.63	19.0	0.75	
10	3/8"	O/ METRIC	ISO 6149-1	M18x1.5 FEMALE ORB	RF 06 F N	34.9	1.37	27.0	1.06	22.0	0.87	24.0	0.94	
12.5	1/2"	O/ SAE	ASME B1.1	1/2" -20 UNF FEMALE ORB	RF 08 F N	46.5	1.83	34.0	1.34	27.0	1.06	27.0	1.06	
20	3/4"	O/ SAE	ASME B1.1	1-1/4" -18 UNEF FEMALE ORB	RF 12 F N	57.0	2.24	45.0	1.77	36.0	1.42	41.0	1.61	
25	1"	O/ SAE	ASME B1.1	1-19/32" -20 UNFEMALE ORB	RF 16 F N	62.5	2.46	55.0	2.17	46.0	1.81	50.0	1.97	

Go to page 240 to find the adaptor table. Other seals available upon request.

RF - Threaded adaptor

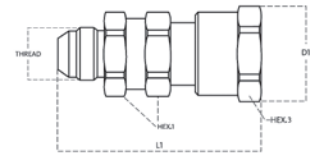

Size		Thread details			FEMALE									
mm	inch	Thread Type	Standard	Thread	Part Number	L (L1 + Thread)		D1		Hex1		Hex3		
						mm	inch	mm	inch	mm	inch	mm	inch	
10	3/8"	F NPTF	ANSI B1.20.3	NPTF 3/8" FEMALE	RF06-38NPT F N	51.3	2.02	27.0	1.06	22.0	0.87	24.0	0.94	
12.5	1/2"	O/ METRIC	ISO 6149-1	M16x1.5 FEMALE ORB	RF 08 1615 F N	73.6	2.90	34.0	1.34	27.0	1.06	30.0	1.18	
20	3/4"	O/ METRIC	ISO 6149-1	M24x1.5 FEMALE ORB	RF 12 2415 F N	82.1	3.23	45.0	1.77	36.0	1.42	41.0	1.61	
20	3/4"	F NPTF	ANSI B1.20.3	NPTF 3/4" FEMALE	RF12-34NPT F N	83.6	3.29	45.0	1.77	36.0	1.42	41.0	1.61	

Other seals available upon request.



RF

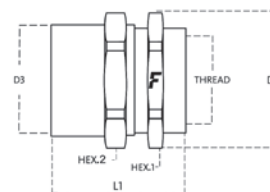

Size		Thread details			MALE									
mm	inch	Thread Type	Standard	Thread	Part Number	L (L1 + Thread)		D1		D3		Hex1		
						mm	inch	mm	inch	mm	inch	mm	inch	
6.3	1/4"	O/SAE	ASME B1.1	1/2" -20 UNF FEMALE ORB	RF 04 M N	27.5	1.08	21.0	0.83	15.8	0.62	19.0	0.75	
10	3/8"	O/METRIC	ISO 6149-1	M18x1.5 FEMALE ORB	RF 06 M N	27.5	1.08	27.0	1.06	20.0	0.79	22.0	0.87	
12.5	1/2"	O/SAE	ASME B1.1	1/2" -20 UNF FEMALE ORB	RF 08 M N	38.5	1.52	34.0	1.34	25.4	1.00	28.0	1.10	
20	3/4"	O/SAE	ASME B1.1	1-1/4" -18 UNF FEMALE ORB	RF 12 M N	44.0	1.73	46.0	1.81	36.5	1.44	41.0	1.61	
25	1"	O/SAE	ASME B1.1	1-19/32" -20 UNFEMALE ORB	RF 16 M N	46.5	1.83	55.0	2.17	44.5	1.75	48.0	1.89	

Go to page 240 to find the adaptor table. Other seals available upon request.

RF - Threaded adaptor

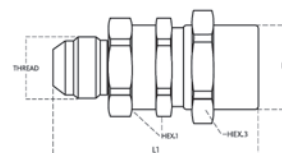

Size		Thread details			MALE									
mm	inch	Thread Type	Standard	Thread	Part Number	L (L1 + Thread)		D1		D3		Hex1		
						mm	inch	mm	inch	mm	inch	mm	inch	
10	1/4"	F NPTF	ANSI B1.20.3	NPTF 3/8" FEMALE	RF06-38NPT M N	44.5	1.75	22.0	0.87	15.8	0.62	22.0	0.87	
12.5	3/8"	O/METRIC	ISO 6149-1	M16x1.5 FEMALE ORB	RF 08 1615 M N	63.5	2.50	34.0	1.34	20.0	0.79	27.0	1.06	
20	1/2"	O/METRIC	ISO 6149-1	M24x1.5 FEMALE ORB	RF 12 2415 M N	69.0	2.72	36.5	1.44	36.5	1.44	36.0	1.42	
20	3/4"	F NPTF	ANSI B1.20.3	NPTF 3/4" FEMALE	RF12-34NPT M N	70.5	2.78	46.0	1.81	36.5	1.44	41.0	1.61	

Other seals available upon request.

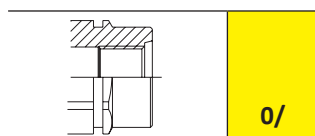
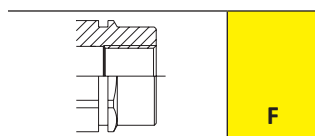

RF Accessories and Spares

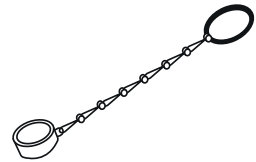
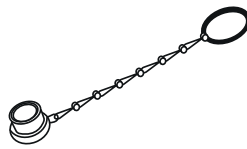

Aluminium dust protections

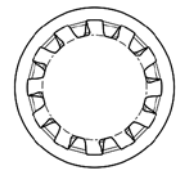

Lock washer for bulkhead mounting