



QTC

Panel mounting flat face couplings fitting custom multiconnections for CE applications

These couplings are designed for CE heavy duty applications and suit custom-designed automatic multiconnection systems, allowing a quick change of hydraulic tools managed from the driver's cab. Easy front installation on plate by seeger rings. High robustness and minimized energy consumption thanks to an optimized design of internal components.



Applications



Pressure Drop

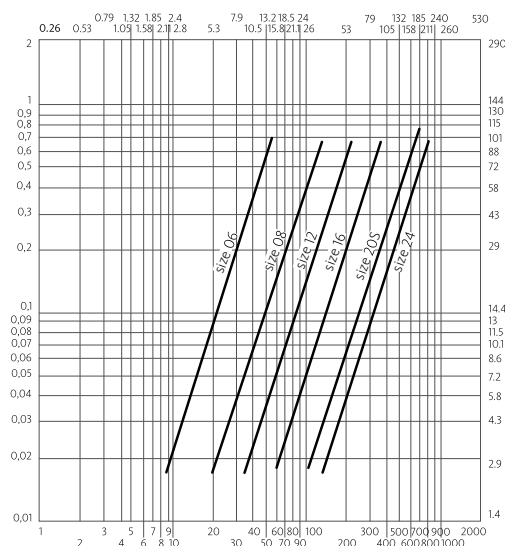

Test performed according to ISO 18869

Technical Specifications

dash	Size mm	inch	Working Pressure (MPa)	Flow Rate (l/min)	Spillage (ml)	Force to Connect (N)	Burst pressure (MPa)		
							Male	Female	Male + Female
06	10	3/8"	46	32		200	140	140	140
08	12.5	1/2"	46	70		200	140	140	140
12	20	3/4"	46	120		300	140	140	140
16	25	1"	46	200		300	140	140	140
20	31.5	1-1/4"	46	350		500	140	140	140
24	37.5	1-1/2"	46	420		500	140	140	140

Material	Steel
Seals	NBR
Working temperatures	- 20 °C to + 120 °C
Surface treatment	MATE 1000 (ZnNi)
Series Interchange	FASTER

Valve Type	Flat
Connection	Push to Connect
Disconnection	Pull to Disconnect
Connection Under Pressure	Allowed Male Half up to 35 MPa (5,000 PSI)



QTC

Size		Thread details			FEMALE								
mm	inch	Thread Type	Standard	Thread	Part Number	L (L1 + Thread)		D1		D2		HEX1	
						mm	inch	mm	inch	mm	inch	mm	inch
10	3/8'	F BSPP	ISO 1179-1	BSPP 3/8" FEMALE	QTC06 38GAS F	77,5	3,05	48	1,89	40	1,57	34	1,34
12,5	1/2'	F BSPP	ISO 1179-1	BSPP 1/2" FEMALE	QTC08 12GAS F	86,2	3,39	55	2,17	48	1,89	41	1,61
20	3/4'	F BSPP	ISO 1179-1	BSPP 3/4" FEMALE	QTC12 34GAS F	103,5	4,07	70	2,76	60	2,36	50	1,97
25	1'	F NPTF	ANSI B1.20.3	NPTF 1" FEMALE	QTC16 1NPT F	108	4,25	80	3,15	70	2,76	60	2,36
31,5	1-1/4'	F NPTF	ANSI B1.20.3	NPTF 1-1/4" FEMALE	QTC20 114NPT F	117,3	4,62	85	3,35	75	2,95	60	2,36
37,5	1-1/2'	F NPTF	ANSI B1.20.3	NPTF 1-1/2" FEMALE	QTC24 112NPT F	138,2	5,44	103	4,06	90	3,54	80	3,15

QTC

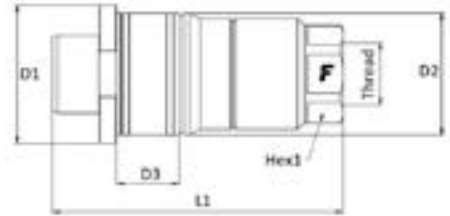

Size		Thread details			MALE								
mm	inch	Thread Type	Standard	Thread	Part Number	L (L1 + Thread)		D1		D2		HEX1	
						mm	inch	mm	inch	mm	inch	mm	inch
10	3/8'	F BSPP	ISO 1179-1	BSPP 3/8" FEMALE	QTC06 38GAS M	96,8	3,81	48	1,89	30	1,18	30	1,18
12,5	1/2'	F BSPP	ISO 1179-1	BSPP 1/2" FEMALE	QTC08 12GAS M	109,5	4,31	55	2,17	48	1,89	36	1,42
20	3/4'	F BSPP	ISO 1179-1	BSPP 3/4" FEMALE	QTC12 34GAS M	122,5	4,82	70	2,76	60	2,36	46	1,81
25	1'	F NPTF	ANSI B1.20.3	NPTF 1" FEMALE	QTC16 1NPT M	143,8	5,66	80	3,15	70	2,76	55	2,17
31,5	1-1/4'	F NPTF	ANSI B1.20.3	NPTF 1-1/4" FEMALE	QTC20 114NPT M	165,8	6,53	85	3,35	75	2,95	55	2,17
37,5	1-1/2'	F NPTF	ANSI B1.20.3	NPTF 1-1/2" FEMALE	QTC24 112NPT M	187,1	7,37	103	4,06	90	3,54	75	2,95