



MF PLV

MultiFaster for harvesting application, 3 lines size 06, 2 lines size 09.

PLV series MultiFaster has been developed for harvesting applications. Interchangeable according to market driven standards. Three lines size 06, two lines size 09.

Applications

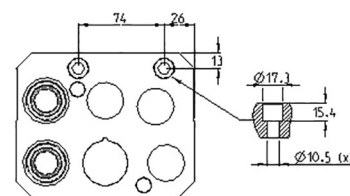
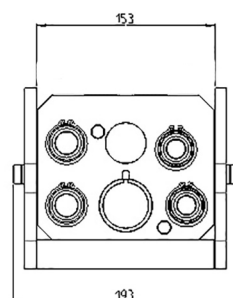
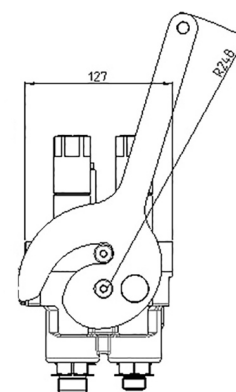
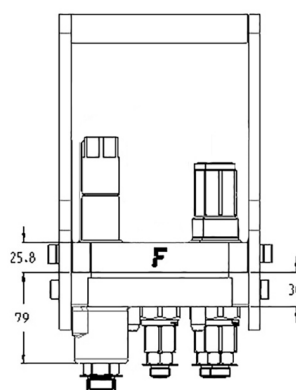

Technical Specifications

dash	Size mm	inch	Working Pressure (MPa)	Flow Rate (l/min)	Spillage (ml)	Burst pressure (MPa)		
						Male	Female	Male + Female
06	10	3/8"	22	20	0.02	69	69	88
09	14.3	9/16"	22	35	0.02	69	69	88

Material	Cast Iron; Steel
Seals	NBR; PUR
Working temperatures	- 25 °C to 100 °C
Surface treatment	MATE 500 (CrIII)

Valve Type	Flat
Connection	Lever
Disconnection	Lever
Connection Under Pressure	Allowed Male Half up to W.P.



PLV

Size			Housing	Number of Couplings	Thread Type			Electrical Connector		FIXED
dash	mm	inch			Thread Type	Standard	Thread	N	Type	Part Number
06	10	3/8"	6	3	11/ SAE	ISO 8434-3	11/16"-16 UN MALE ORFS		3PLV-0-5-A F C	
09	14.3	9/16"		1	11/ SAE	ISO 8434-3	13/16"-16 UN MALE ORFS			
09	14.3	9/16"		1	11/ SAE	ISO 8434-3	1"-14 UNS MALE ORFS			

Size			Housing	Number of Couplings	Thread Type			Electrical Connector		MOBILE
dash	mm	inch			Thread Type	Standard	Thread	N	Type	Part Number
06	10	3/8"	6	1	11/ SAE	ISO 8434-3	11/16"-16 UN MALE ORFS		3PLV-0-3-B M C	
09	14.3	9/16"		1	11/ SAE	ISO 8434-3	1"-14 UNS MALE ORFS			
09	14.3	9/16"		1	11/ SAE	ISO 8434-3	13/16"-16 UN MALE ORFS			
06	10	3/8"	6	3	11/ SAE	ISO 8434-3	11/16"-16 UN MALE ORFS		3PLV-0-5-B M C	
09	14.3	9/16"		1	11/ SAE	ISO 8434-3	1"-14 UNS MALE ORFS			
09	14.3	9/16"		1	11/ SAE	ISO 8434-3	13/16"-16 UN MALE ORFS			
06	10	3/8"	6	3	11/ SAE	ISO 8434-3	11/16"-16 UN MALE ORFS		3PLV-0-5-C M C	
09	14.3	9/16"		2	0/ SAE	ISO 11926-1	7/8"-14 UNF FEMALE ORB			
06	10	3/8"	6	3	11/ SAE	ISO 8434-3	11/16"-16 UN MALE ORFS		3PLV-0-5-A M C	
09	14.3	9/16"		1	11/ SAE	ISO 8434-3	13/16"-16 UN MALE ORFS			
09	14.3	9/16"		1	11/ SAE	ISO 8434-3	1"-14 UNS MALE ORFS			
06	10	3/8"	6	2	0/ SAE	ISO 11926-1	3/4" - 16 UNF FEMALE ORB		3PLV-0-4-A M C	
09	14.3	9/16"		2	0/ SAE	ISO 11926-1	7/8"-14 UNF FEMALE ORB			
06	10	3/8"	6	2	11/ SAE	ISO 8434-3	11/16"-16 UN MALE ORFS		3PLV-0-2-A M C	

Spare Parts & Accessories

Female Half				Male Half					
Plates	Lever	Dust cover	Safety Lock	Plates	Seals male	Screws	Plugs	Guiding pins	Docking
KIT PLV F L	KIT LPLV			KIT PLV M	SK MF 38	KIT VPLK M	KIT TSP 12 M		
					SK MF 916		KIT TPLK 32		

