

# OGV



## Screw to connect couplings for oil & gas application, market interchange.

Standard screw to connect coupling suitable for Oil & Gas applications. Robust sleeve design, poppet valve and ACME connection thread.



## Applications



## Pressure Drop

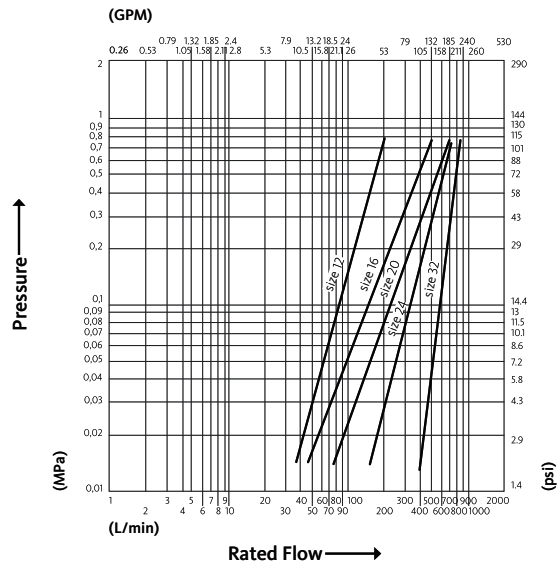

## Technical Specifications

dash	Size mm	inch	Working Pressure (MPa)	Flow Rate (l/min)	Spillage (ml)	Force to Connect (N)	Burst pressure (MPa)		
							Male	Female	Male + Female
12	20	3/4"	35	120	8	168	160	165	
16	25	1"	35	230	18	165	165	172	
20	31.5	1-1/4"	35	320	21	180	200	178	
24	37.5	1-1/2"	35	330	41	160	176	170	
32	50	2"	35	570	85	125	130	125	

Material	<b>Steel</b>
Seals	<b>NBR; PUR</b>
Working temperatures	<b>- 25 °C to + 100 °C</b>
Surface treatment	<b>MATE 500 (CrIII)</b>
Series Interchange	<b>MARKET</b>

Valve Type	<b>Poppet</b>
Connection	<b>Screw to Connect</b>
Disconnection	<b>Unscrew to Disconnect</b>
Connection Under Pressure	<b>Allowed Residual</b>



OGV

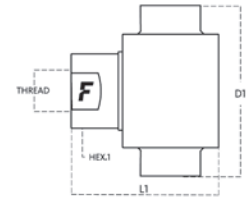

Size		Thread details			FEMALE							
mm	inch	Thread Type	Standard	Thread	Part Number	L (L1 + Thread)		D1		HEX1		
						mm	inch	mm	inch	mm	inch	
20	3/4"	F NPSF	ANSI B1.20.3	NPSF 3/4 FEMALE	OGV12 34NPS F	72.2	2.84	55	2.17	32	1.26	
25	1"	F NPSF	ANSI B1.20.3	NPSF 1 FEMALE	OGV16 1NPS F	87.6	3.45	105.5	4.15	41	1.61	
31.5	1-1/4"	F NPTF	ANSI B1.20.3	NPTF 1-1/4" FEMALE	OGV20 114NPT F	111.9	4.41	118.2	4.65	50	1.97	
37.5	1-1/2"	F NPTF	ANSI B1.20.3	NPTF 1-1/2" FEMALE	OGV24 112NPT F	127.1	5	147	5.79	55	2.17	
50	2"	F NPTF	ANSI B1.20.3	NPTF 2" FEMALE	OGV32 2NPT F	154.2	6.07	170	6.69	75	2.95	

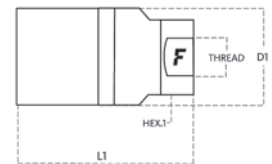

Size		Thread details			MALE								
mm	inch	Thread Type	Standard	Thread	Part Number	L (L1 + Thread)		D1		D3		HEX1	
						mm	inch	mm	inch	mm	inch	mm	inch
20	3/4"	F NPSF	ANSI B1.20.3	NPSF 3/4 FEMALE	OGV12 34NPS M	83.1	3.27	44.25	1.74			32	1.26
25	1"	F NPSF	ANSI B1.20.3	NPSF 1 FEMALE	OGV16 1NPS M	106	4.17	57.12	2.25			41	1.61
31.5	1-1/4"	F NPTF	ANSI B1.20.3	NPTF 1-1/4" FEMALE	OGV20 114NPT M	136.5	5.37	66.65	2.62			50	1.97
37.5	1-1/2"	F NPTF	ANSI B1.20.3	NPTF 1-1/2" FEMALE	OGV24 112NPT M	151.7	5.97	82.52	3.25			55	2.17
50	2"	F NPTF	ANSI B1.20.3	NPTF 2" FEMALE	OGV32 2NPT M	179.1	7.05	101.57	4			75	2.95

## OGV Accessories and Spares



### Aluminium dust protections

