

# OGV ST

**Screw to connect couplings for Oil & Gas application, market interchange. Equipped with a marker that confirms the complete connection and a longer locking sleeve for an improved engagement.**

Screw-to-connect coupling suitable for Oil & Gas applications. Robust sleeve design, poppet valve and ACME connection thread. Equipped with a marker that confirms the complete connection and a longer locking sleeve for an improved engagement.



## Applications



## Pressure Drop

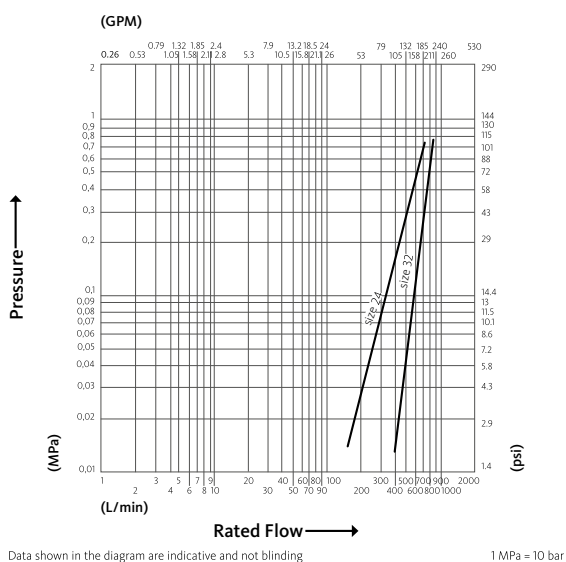

Data shown in the diagram are indicative and not binding

1 MPa = 10 bar

Test performed according to ISO 18869

## Technical Specifications

dash	Size		Working Pressure (MPa)	Flow Rate (l/min)	Spillage (ml)	Force to Connect (N)	Burst pressure (MPa)		
	mm	inch					Male	Female	Male + Female
24	37.5	1-1/2"	35	330	41	160	176	170	
32	50	2"	35	570	80	125	130	125	

Material	<b>Steel</b>
Seals	<b>NBR; PUR</b>
Working temperatures	<b>- 25 ° C + 100 ° C</b>
Surface treatment	<b>MATE 500 (CrIII)</b>
Series Interchange	<b>MARKET</b>

Valve Type	<b>Poppet</b>
Connection	<b>Screw to Connect</b>
Disconnection	<b>Unscrew to Disconnect</b>
Connection Under Pressure	<b>Allowed Residual</b>

**OGV ST**

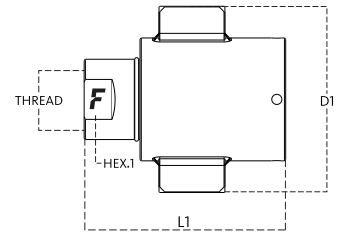

Size		Thread details			FEMALE						
mm	inch	Thread Type	Standard	Thread	Part Number	L (L1 + Thread)		D1		HEX1	
						mm	inch	mm	inch	mm	inch
37.5	1-1/2"	F BSPP	ISO 1179-1	BSPP 1-1/2" FEMALE	OGV24 112GAS F ST	159,1	6,26	147	5,79	55	2,17
50	2"	F BSPP	ISO 1179-1	BSPP 2" FEMALE	OGV32 2GAS F ST	186,4	7,34	170	6,69	75	2,95

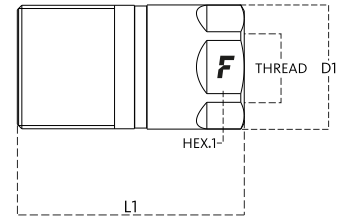

Size		Thread details			MALE						
mm	inch	Thread Type	Standard	Thread	Part Number	L (L1 + Thread)		D1		HEX1	
						mm	inch	mm	inch	mm	inch
37.5	1-1/2"	F BSPP	ISO 1179-1	BSPP 1-1/2" FEMALE	OGV24 112GAS M ST	151,7	5,97	83	3,27	75	2,95
50	2"	F BSPP	ISO 1179-1	BSPP 2" FEMALE	OGV32 2GAS M ST	179,1	7,05	103	6,69	75	2,95

