

# CNV



## Male couplings for agriculture, suitable for CPV female parts, ISO 7241 part A interchange.

Standard male couplings for agriculture applications. Wide range of male threads available. ISO 7241 part A interchange.



## Applications



## Pressure Drop

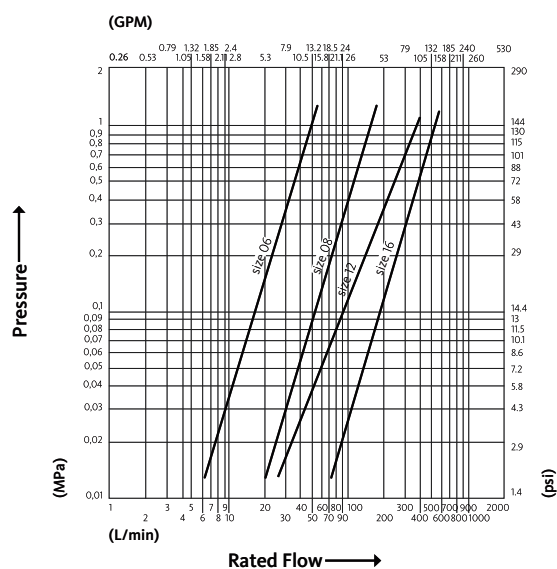

Test performed according to ISO 18869

## Technical Specifications

dash	Size mm	inch	Working Pressure (MPa)	Flow Rate (l/min)	Spillage (ml)	Force to Connect (N)	Burst pressure (MPa)		
							Male	Female	Male + Female
06	10	3/8"	27	24	1.3	120	115	110	
08	12.5	1/2"	25	75	1.8	110	100	100	
12	20	3/4"	25	160	8	250	100	100	
16	25	1"	22	270	13	220	100	90	

Material	<b>Steel</b>
Seals	<b>NBR</b>
Working temperatures	<b>- 25 °C to + 125 °C</b>
Surface treatment	<b>MATE 500 (CrIII)</b>
Series Interchange	<b>ISO 7241 part A</b>

Valve Type	<b>Poppet</b>
Connection	<b>Sleeve Retraction</b>
Disconnection	<b>Sleeve Retraction</b>
Connection Under Pressure	<b>Not Allowed</b>



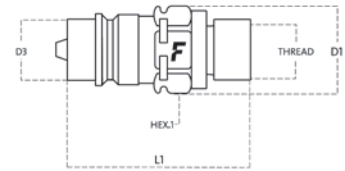

Size		Thread details			MALE									
mm	inch	Thread Type	Standard	Thread	Part Number	L (L1 + Thread)		D1		D3		HEX1		
						mm	inch	mm	inch	mm	inch	mm	inch	
10	3/8"	07/ METRIC	ISO 8434-1-L	M18x1.5 MALE BULKHEAD SHORT 12L	CNV067/1815 M	69.2	2.72	27	1.06	17.2	0.68	24	0.94	
10	3/8"	02/ METRIC	ISO 8434-1-L	M18x1.5 MALE 12L	CNV062/1815 M	54.2	2.13	26	1.02	17.2	0.68	24	0.94	
10	3/8"	02/ METRIC	ISO 8434-1-L	M16x1.5 MALE 10L	CNV062/1615 M	54.2	2.13	26	1.02	17.2	0.68	24	0.94	
10	3/8"	01/ SAE	ISO 11926-3	3/4"-16 UNF MALE	CNV061/12SAE M	53	2.09	26	1.02	17.2	0.68	24	0.94	
10	3/8"	0/ METRIC	ISO 6149-1	M14x1.5 FEMALE ORB	CNV060/1415 M	53	2.09	26	1.02	17.2	0.68	24	0.94	
12.5	1/2"	08/ METRIC	ISO 8434-1-S	M22x1.5 MALE BULKHEAD SHORT	CNV088/2215 M	72	2.83	30	1.18	20.5	0.81	27	1.06	
12.5	1/2"	07/ METRIC	ISO 8434-1-L	M18x1.5 MALE BULKHEAD SHORT 12L	CNV087/1815 M	72	2.83	30	1.18	20.5	0.81	27	1.06	
12.5	1/2"	07/ METRIC	ISO 8434-1-L	M16x1.5 MALE BULKHEAD SHORT 10L	CNV087/1615 M	73.5	2.89	30	1.18	20.5	0.81	27	1.06	
12.5	1/2"	06/ METRIC	ISO 8434-1-S	M20x1.5 MALE BULKHEAD 12S	CNV086/2015 M	81	3.19	30	1.18	20.5	0.81	27	1.06	
12.5	1/2"	05/ METRIC	ISO 8434-1-L	M22x1.5 MALE BULKHEAD 15L	CNV085/2215 M	81	3.19	30	1.18	20.5	0.81	27	1.06	
12.5	1/2"	05/ METRIC	ISO 8434-1-L	M16x1.5 MALE BULKHEAD 10L	CNV085/1615 M	81	3.19	30	1.18	20.5	0.81	27	1.06	
12.5	1/2"	04/ BSPP	ISO 8434-6	60° 1/2" BSPP MALE BULKHEAD	CNV084/12GAS M	82.5	3.25	30	1.18	20.5	0.81	27	1.06	
12.5	1/2"	03/ METRIC	ISO 8434-1-S	M24x1.5 MALE 16S	CNV083/2415 M	60	2.36	30	1.18	20.5	0.81	27	1.06	
12.5	1/2"	03/ METRIC	ISO 8434-1-S	M20x1.5 MALE 12S	CNV083/2015 M	58	2.28	30	1.18	20.5	0.81	27	1.06	
12.5	1/2"	27/ SAE	ISO 8434-3	1" - 14 UNS	CNV0827/58SAE M	64	2.52	33	1.3	20.5	0.81	30	1.18	
12.5	1/2"	22/ BSPP	DIN 3852-2-A	1/2 BSPP MALE	CNV0822/12GAS M	60	2.36	30	1.18	20.5	0.81	27	1.06	
12.5	1/2"	02/ METRIC	ISO 8434-1-L	M26x1.5 MALE 18L	CNV082/2615 M	58	2.28	30	1.18	20.5	0.81	27	1.06	
12.5	1/2"	02/ METRIC	ISO 8434-1-L	M14x1.5 MALE 8L	CNV082/1415 M	59	2.32	30	1.18	20.5	0.81	27	1.06	
12.5	1/2"	02/ METRIC	ISO 8434-1-L	M18x1.5 MALE 12L	CNV082/1815 M7	57	2.24	30	1.18	20.5	0.81	27	1.06	
12.5	1/2"	02/ METRIC	ISO 8434-1-L	M22x1.5 MALE 15L	CNV082/2215 M7	57	2.24	30	1.18	20.5	0.81	27	1.06	
12.5	1/2"	16/ BSPP	ISO 8434-6	60° 1/2 BSPP MALE	CNV0816/12GAS M	60	2.36	30	1.18	20.5	0.81	27	1.06	
12.5	1/2"	14/ SAE	ISO 8434-2	3/4"-16 UN MALE BULKHEAD JIC	CNV0814/12SAE M	83	3.27	30	1.18	20.5	0.81	27	1.06	
12.5	1/2"	12/ SAE	ISO 8434-3	13/16"-16 UN MALE BULKHEAD ORFS	CNV0812/12SAE M	80.5	3.17	30	1.18	20.5	0.81	27	1.06	
12.5	1/2"	01/ METRIC	ISO 6149-2	M27x2 MALE	CNV081/272 M	67	2.64	35	1.38	20.5	0.81	32	1.26	
12.5	1/2"	21/ METRIC	ISO 9974-2	M22x1.5 MALE	CNV081/2215 M	61	2.4	30	1.18	20.5	0.81	27	1.06	
12.5	1/2"	01/ METRIC	ISO 6149-2	M18x1.5 MALE	CNV081/1815 M	60	2.36	30	1.18	20.5	0.81	27	1.06	
12.5	1/2"	01/ SAE	ISO 11926-3	3/4"-16 UNF MALE	CNV081/12SAE M	57	2.24	30	1.18	20.5	0.81	27	1.06	
12.5	1/2"	0/ BSPP	BS 5380	3/8 BSP FEMALE ORB	CNV080/38GAS M	57	2.24	30	1.18	20.5	0.81	27	1.06	
12.5	1/2"	0/ METRIC	ISO 6149-1	M22x1.5 FEMALE ORB	CNV080/2215 M	61	2.4	30	1.18	20.5	0.81	27	1.06	
12.5	1/2"	0/ METRIC	ISO 6149-1	M20x1.5 FEMALE ORB	CNV080/2015 M	60	2.36	30	1.18	20.5	0.81	27	1.06	
12.5	1/2"	0/ METRIC	ISO 6149-1	M18x1.5 FEMALE ORB	CNV080/1815 M	57	2.24	30	1.18	20.5	0.81	27	1.06	
12.5	1/2"	0/ METRIC	ISO 6149-1	M16x1.5 FEMALE ORB	CNV080/1615 M	57	2.24	30	1.18	20.5	0.81	27	1.06	
12.5	1/2"	F BSPP	ISO 1179-1	BSPP 3/8" FEMALE	CNV08 38 GAS M	57	2.24	30	1.18	20.5	0.81	27	1.06	
12.5	1/2"	05/ METRIC	ISO 8434-1-L	M18x1.5 MALE BULKHEAD 12L	CNV085/1815 M	78	3.07	30	1.18	20.5	0.81	27	1.06	
12.5	1/2"	07/ METRIC	ISO 8434-1-L	M22x1.5 MALE BULKHEAD SHORT 15L	CNV087/2215 M	72	2.83	30	1.18	20.5	0.81	27	1.06	
12.5	1/2"	36/ BSP	ISO 8434-6	60° 1/2 BSP MALE	CNV0836/12GAS M	89	3.5	30	1.18	20.5	0.81	27	1.06	
12.5	1/2"	16/ BSPP	ISO 8434-6	60° 3/8 BSPP MALE	CNV0816/38GAS M	59.5	2.34	30	1.18	20.5	0.81	27	1.06	
12.5	1/2"	02/ METRIC	ISO 8434-1-L	M16x1.5 MALE 10L	CNV082/1615 M	58.5	2.3	30	1.18	20.5	0.81	27	1.06	
12.5	1/2"	02/ METRIC	ISO 8434-1-L	M22x1.5 MALE 15L	CNV082/2215 M	58	2.28	30	1.18	20.5	0.81	27	1.06	
12.5	1/2"	02/ METRIC	ISO 8434-1-L	M18x1.5 MALE 12L	CNV082/1815 M	57	2.24	30	1.18	20.5	0.81	27	1.06	
20	3/4"	07/ METRIC	ISO 8434-1-L	M36x2 MALE BULKHEAD SHORT 28L	CNV127/362 M	100.2	3.94	51.5	2.03	29	1.14	41	1.61	

CNV

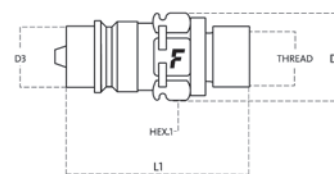

Size		Thread details			MALE								
mm	inch	Thread Type	Standard	Thread	Part Number	L (L1 + Thread)		D1		D3		HEX1	
						mm	inch	mm	inch	mm	inch	mm	inch
20	3/4"	05/ METRIC	ISO 8434-1-L	M45x2 MALE BULKHEAD 35L	CNV125/452 M	114.2	4.5	62	2.44	29	1.14	55	2.17
20	3/4"	05/ METRIC	ISO 8434-1-L	M36x2 MALE BULKHEAD 28L	CNV125/362 M	109	4.29	51.5	2.03	29	1.14	41	1.61
20	3/4"	05/ METRIC	ISO 8434-1-L	M30x2 MALE BULKHEAD 22L	CNV125/302 M	101.2	3.98	46	1.81	29	1.14	36	1.42
20	3/4"	03/ METRIC	ISO 8434-1-S	M30x2 MALE 20S	CNV123/302 M	83.2	3.28	38	1.5	29	1.14	34	1.34
20	3/4"	12/ SAE	ISO 8434-3	1 3/16" - 12 UN MALE BULKHEAD ORFS	CNV1212/34SAE M	106.7	4.2	42	1.65	29	1.14	36	1.42
20	3/4"	12/ SAE	ISO 8434-3	1 7/16" - 12 UN MALE BULKHEAD ORFS	CNV1212/1SAE M	109.2	4.3	50	1.97	29	1.14	42	1.65
20	3/4"	01/ METRIC	ISO 6149-2	M27x2 MALE	CNV121/272 M	86.5	3.41	35	1.38	29	1.14	32	1.26
20	3/4"	01/ METRIC	ISO 6149-2	M22x1.5 MALE	CNV121/2215 M	86.5	3.41	35	1.38	29	1.14	32	1.26
20	3/4"	0/ METRIC	ISO 6149-1	M27x2 FEMALE ORB	CNV120/272 M	85.5	3.37	38	1.5	29	1.14	34	1.34
25	1"	03/ METRIC	ISO 8434-1-S	M30x2 MALE 20S	CNV163/302 M	75	2.95	42.5	1.67	34.3	1.35	38	1.5
25	1"	02/ METRIC	ISO 8434-1-L	M36x2 MALE 28L	CNV162/362 M	70	2.76	42.5	1.67	34.3	1.35	38	1.5
25	1"	02/ METRIC	ISO 8434-1-L	M30x2 MALE 22L	CNV162/302 M	71.5	2.81	42.5	1.67	34.3	1.35	38	1.5
25	1"	0/ BSPP	BS 5380	3/4 BSP FEMALE ORB	CNV160/34GAS M	72	2.83	42.5	1.67	34.3	1.35	38	1.5
25	1"	0/ BSPP	BS 5380	1 BSP FEMALE ORB	CNV160/1GAS M	75	2.95	46	1.81	34.3	1.35	42	1.65
25	1"	F BSPP	ISO 1179-1	BSPP 1" FEMALE	CNV16 34GAS M	72	2.83	42.5	1.67	34.3	1.35	38	1.5
25	1"	F BSPP	ISO 1179-1	BSPP 1" FEMALE	CNV16 1GAS M	77	3.03	46	1.81	34.3	1.35	42	1.65

Part Numbers ending in 7 have Zn-Ni surface treatment for improved resistance against wear and corrosion.

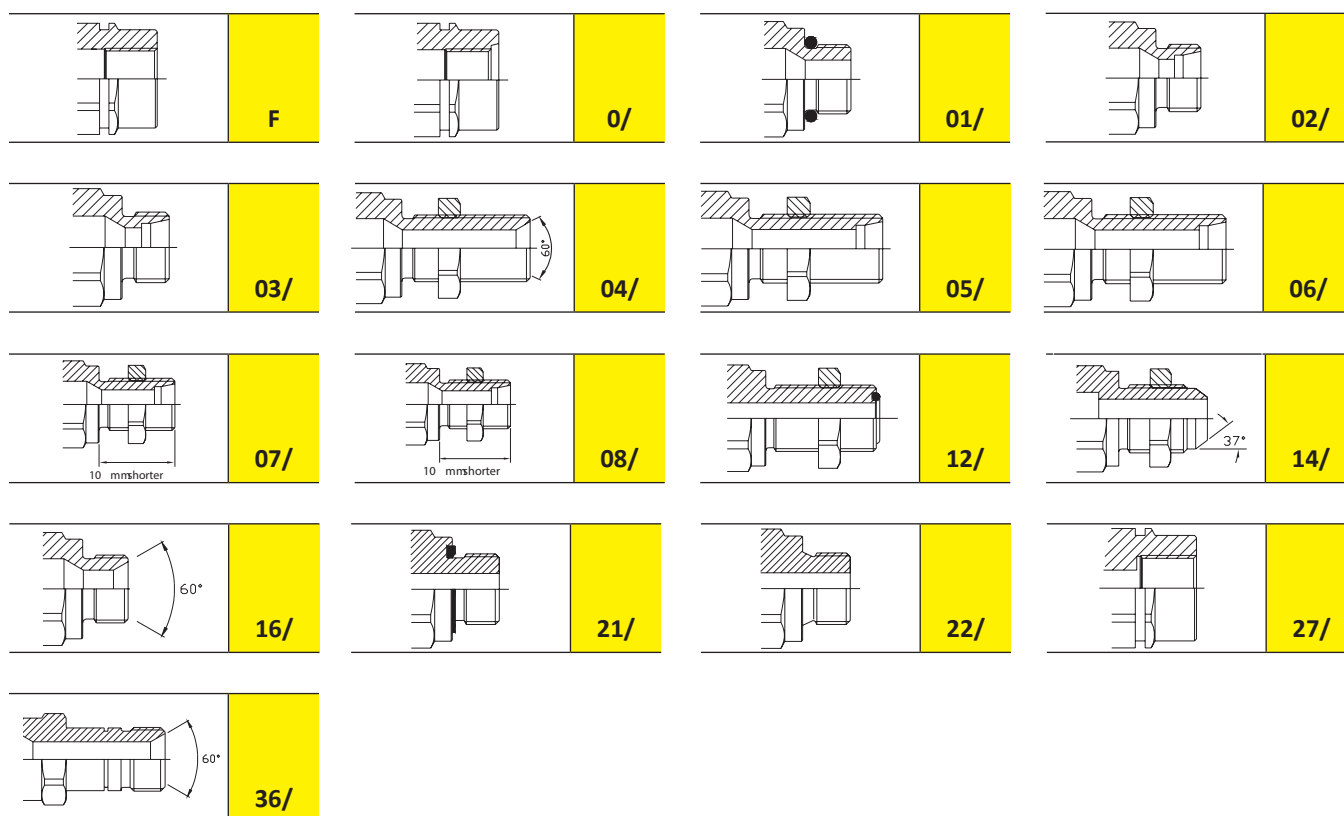

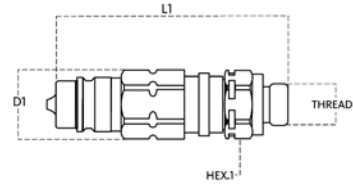

## CNV for FastGrip

Size		Thread details			MALE									
mm	inch	Thread Type	Standard	Thread	Part Number	L (L1 + Thread)		D1		D3		HEX1		
						mm	inch	mm	inch	mm	inch	mm	inch	
12.5	1/2"	02/METRIC	ISO 8434-1-L	M18x1.5 MALE 12L	CNV08LM2/18 M	102	4.02	30	1.18	20.5	0.81	27	1.06	
12.5	1/2"	02/METRIC	ISO 8434-1-L	M22x2 MALE 15L	CNV08LM2/22 M	103	4.06	30	1.18	20.5	0.81	27	1.06	

## CNV Accessories and Spares



### PVC dust protections



### Aluminium dust protections

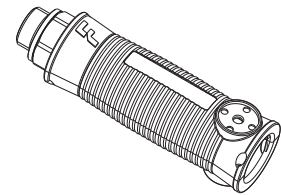

### Line Identification System



### Seals Kits

