

# Auxiliary Lines Block (3 ports)

## Castings with 3 couplings for construction equipment

The first cast iron block ever designed allowing a quick connection and disconnection of attachments for skid steer loaders and other construction equipment machines. Cartridges share all the benefits of the FFH series technology. The decompression feature allows to connect the circuit with residual pressure on both ends. Higher flow capability is guaranteed when using 3/4" cartridges instead of 1/2" (both the sizes fit into the same block).

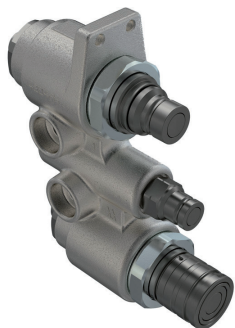

## Applications



## Pressure Drop

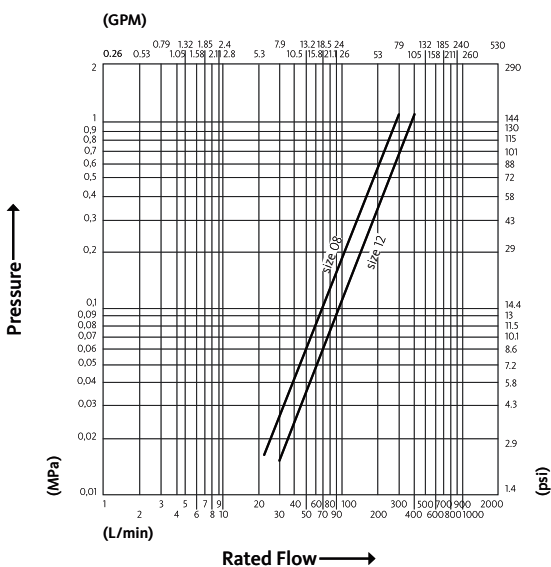

Test performed according to ISO 18869

## Technical Specifications

dash	Size mm	inch	Working Pressure (MPa)	Flow Rate (l/min)	Spillage (ml)	Force to Connect (N)	Burst pressure (MPa)		
							Male	Female	Male + Female
08	12.5	1/2"	35	100	0.01	200	125	125	125
12	20	3/4"	35	145	0.02	230	125	125	125

Material	Cast Iron; Steel
Seals	NBR; PUR
Working temperatures	- 25 °C to + 100 °C
Surface treatment	MATE 500 (CrIII); MATE 1000 (ZnNi)
Series Interchange	ISO 16028

Valve Type	Flat
Connection	Push to Connect
Disconnection	Sleeve Retraction
Connection Under Pressure	Allowed Both Halves up to W.P.



## Auxiliary Lines Block (3 ports)

Size		Thread details									
mm	inch	Thread Type	Standard	Thread	Part Number	L (L1 + Thread)		D1		HEX1	
						mm	inch	mm	inch	mm	inch
12.5	1/2'	11/ SAE	ISO 8434-3	13/16"-16 UN MALE ORFS	4BD4FH08-11/12S	178,7	7,04				
12.5	1/2'	11/ SAE	ISO 8434-3	1-7/16"-12 UN MALE ORFS	4BD4FH08-11/1S	183,2	7,21				
12.5	1/2'	11/ SAE	ISO 8434-3	1-3/16"-12 UN MALE ORFS	4BD4FH08-11/34S	182,7	7,19				
12.5	1/2'	13/ SAE	ISO 8434-2	1-1/16"-12 UN MALE JIC	4BD4FH08-13/34S	187,6	7,39				
12.5	1/2'	13/ SAE	ISO 8434-2	7/8"-14 UNF MALE JIC	4BD4FH08-13/58S	185	7,28				
12.5	1/2'	03/ METRIC	ISO 8434-1-S	M24x1.5 Male	4BD4FH08-3/241S	180	7,09				
12.5	1/2'	0/ SAE	ISO 11926-1	7/8"-14 UNF FEMALE ORB	4BD4FH08-58SAE	187,5	7,38				
12.5	1/2'	11/ SAE	ISO 8434-3	1-3/16"-12 UN MALE ORFS	4BD4FH08-A	192,4	7,57				
12.5	1/2'	F BSPP	ISO 1179-1	BSPP 3/4" FEMALE	4BD4FH08-C	187,5	7,38				
12.5	1/2'	61/ SAE	ISO 8434-2	1-1/16"-12 UN 90° MALE	4BD4FH08-D	215	8,46				
12.5	1/2'	13/ SAE	ISO 8434-2	7/8"-14 UNF MALE JIC	4BD4FH08-E	194,7	7,67				
12.5	1/2'	11/ SAE	ISO 8434-3	1-3/16"-12 UN MALE ORFS	4BD4FH08-F	189	7,44				
20	3/4'	13/ SAE	ISO 8434-2	1 - 5/16" - 12 UN MALE JIC	4BD4FH12-13/1S	208,6	8,21				
20	3/4'	13/ SAE	ISO 8434-2	1-1/16"-12 UN MALE JIC	4BD4FH12-13/34S	207,4	8,17				
20	3/4'	11/ SAE	ISO 8434-3	1-7/16"-12 UN MALE ORFS	4BD4FH12-B	209,3	8,24				
20	3/4'	F BSPP	ISO 1179-1	BSPP 3/4" FEMALE	4BD4FH12-C	207,3	8,16				