

---

## Dust Cap Replacement (2 Hinges)

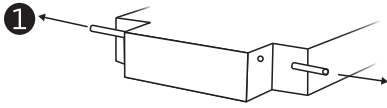

Carefully remove the pins.

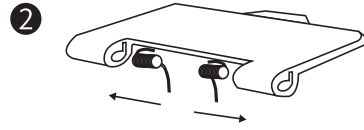

Insert the springs into their seats.

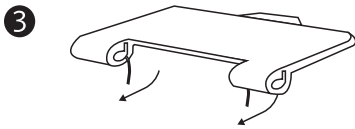

Load the springs terminal.

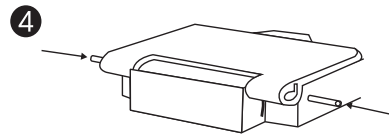

Position the dust cap and insert the pins up to the edge.

## Dust Cap Replacement (1 Hinge)

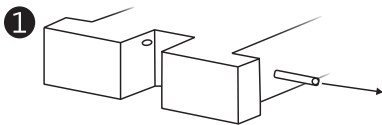

Carefully remove the pins.

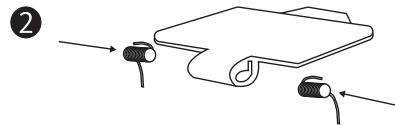

Insert the springs into their seats.

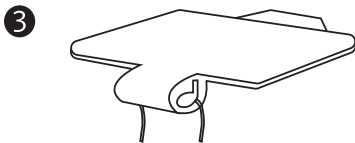

Load the springs terminal.

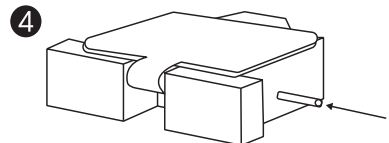

Position the dust cap and insert the pins up to the edge.